

1970 LF PRESS VALVE

Lead free brass ball valve with EURO-PRESS connections, full port.

- Test pressure rating 600 psi, working pressure 200 psi.
- Temperature range -4°F to 250°F.
- Made in lead free dezincification resistant brass (LF-DZR).
- Blow-out proof stem, SLT coated LF brass ball.
- PTFE seats, seals, and thrust washer.
- Adjustable stem packing.
- 100% electronically tested in the open and closed position at 80 psi.
- Valve to be used in fully open or fully closed position.
- Press alert O-rings.

1970 LF: size 1/2" to 2".

For size 2 1/2", 3" and 4" see 1670XLC LF.

Technical specifications

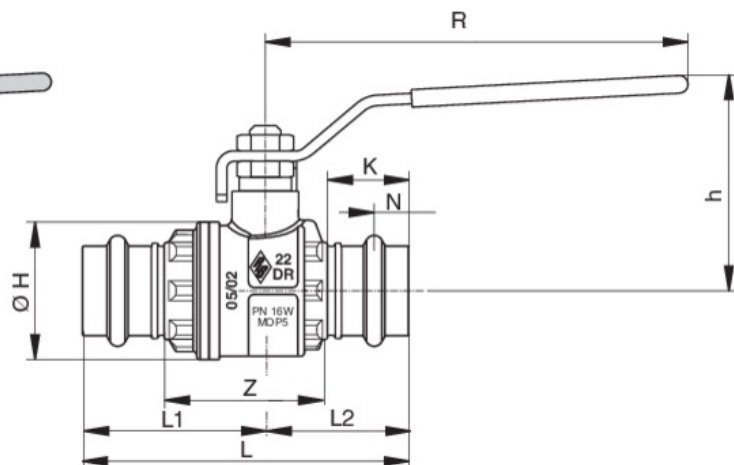
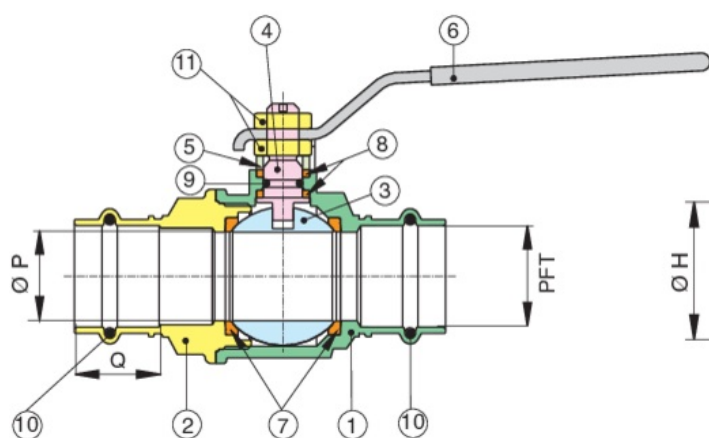



| POSITION | PART NAME | MATERIAL | N.° PIECES |
|----------|-------------------------|----------------------|------------|
| 1 | BODY | LF DZR BRASS C27453* | 1 |
| 2 | END CONNECTION | LF DZR BRASS C27453* | 1 |
| 3 | BALL | LF BRASS C28500* | 1 |
| 4 | STEM | LF BRASS C28500* | 1 |
| 5 | PACKING GLAND | BRASS C38500 | 1 |
| 6 | HANDLE | STEEL DD11 | 1 |
| 7 | BALL SEAT | PTFE | 2 |
| 8 | STEM SEAL/THRUST WASHER | PTFE | 2 |
| 9 | O-RING | NBR | 1 |
| 10 | O-RING | EPDM PEROX | 2 |
| 11 | NUT | STEEL CL 04 | 2 |

* **Lead free** refers to the wetted surface of pipe, fittings and fixtures in potable water systems that have a weighted average lead content not more than 0.25%. Source: California health & Safety code (116875). Vermont Act 193.

| PFT | ØP | Z | K | N | ØH | L | L1 | L2 | H | R | CV | MAX WORK PRESS (PSI) | MAX TEST PRESS (PSI) | WEIGHT (LBS) |
|--------|------|------|------|------|------|------|------|------|------|------|--------|----------------------|----------------------|--------------|
| 1/2" | 0.59 | 1.61 | 0.67 | 0.31 | 1.3 | 2.99 | 1.71 | 1.3 | 1.89 | 3.78 | 18.84 | 200 | 600 | 0.45 |
| 3/4" | 0.79 | 1.69 | 0.83 | 0.39 | 1.57 | 3.5 | 1.93 | 1.57 | 2.32 | 4.76 | 34.1 | 200 | 600 | 0.85 |
| 1" | 0.98 | 2.03 | 0.83 | 0.39 | 1.93 | 3.92 | 2.19 | 1.73 | 2.48 | 4.76 | 49.71 | 200 | 600 | 1.24 |
| 1 1/4" | 1.26 | 2.19 | 0.83 | 0.39 | 2.32 | 4.23 | 2.3 | 1.93 | 2.99 | 5.94 | 102.89 | 200 | 600 | 2.01 |
| 1 1/2" | 1.57 | 2.5 | 1.02 | 0.49 | 2.87 | 5.33 | 2.78 | 2.56 | 3.25 | 5.94 | 265.9 | 200 | 600 | 3.24 |
| 2" | 1.95 | 3.13 | 1.26 | 0.59 | 3.43 | 6.28 | 3.3 | 2.98 | 3.78 | 6.3 | 306.36 | 200 | 600 | 5.43 |

WARNING: This product can expose you to chemicals including lead, which is known to the State of California to cause cancer and birth defects or other reproductive harm. For more information go to www.p65warnings.ca.gov.

Diagrams

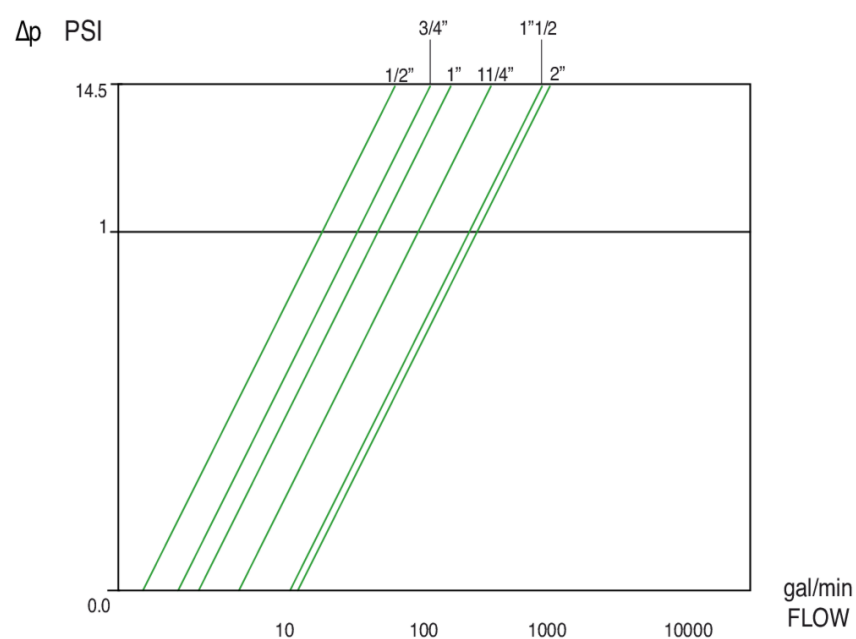
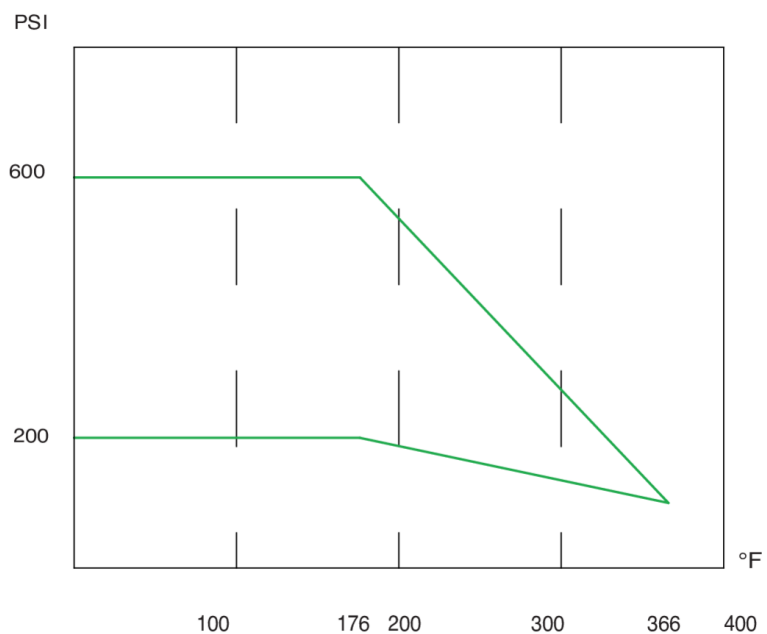

Certifications



UL certified

HEALTH
EFFECTS
UL-QA NSF572
NSF61

HEALTH EFFECTS



200 WOG

FM-200 WOG



TSSA