

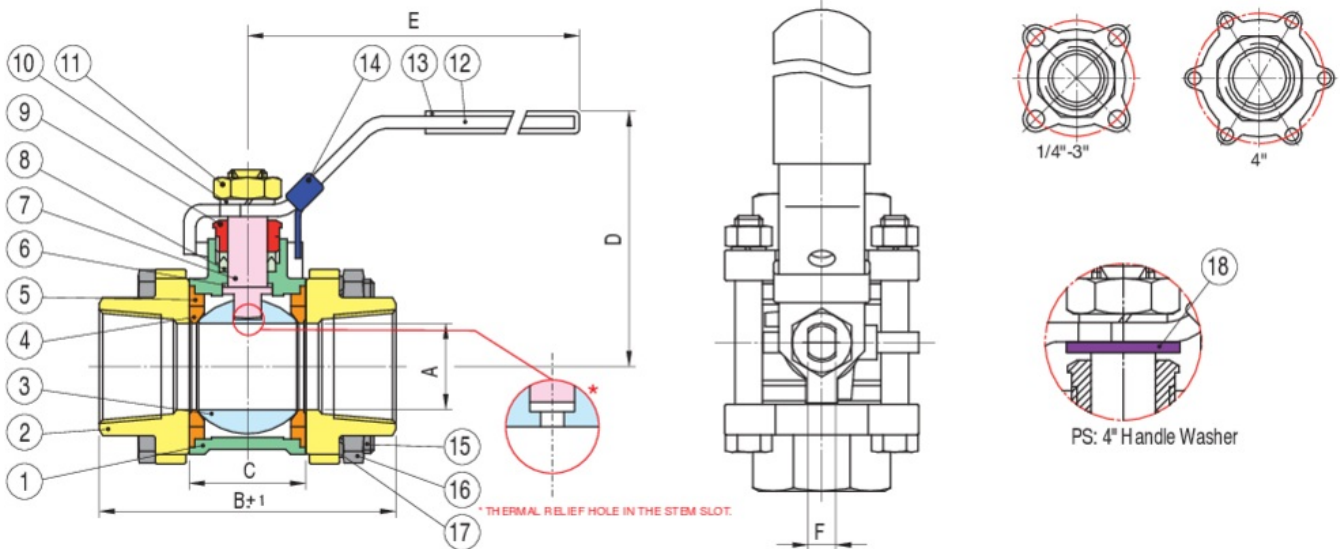

## 710LL FNPT - 711LL SW

- 3-piece ball valve, with latch locking lever, full port.
- Pressure rating 1/4" to 2" 1000 psi, 2 1/2" to 4" 800 psi - 150 psi steam.
  - Temperature range -40°F + 440°F.
  - Blow-out proof stem, adjustable multi-layer V-ring stem packaging.
  - TFM 1600 seats, PTFE packing and thrust washer.
- 710 LL: FNPT THREADED - size 1/4" to 4".  
711 LL: SOCKET WELD - size 1/4" to 4".

### Technical specifications



| POSITION | PART NAME      | MATERIAL | N.° PIECES |
|----------|----------------|----------|------------|
| 1        | BODY           | CF8M     | 1          |
| 2        | END CAP        | CF8M     | 2          |
| 3        | BALL           | AISI 316 | 1          |
| 4        | SEAT           | TFM1600  | 2          |
| 5        | JOIN GASKET    | PTFE     | 2          |
| 6        | STEM SEAL      | PTFE     | 1          |
| 7        | STEM           | AISI 316 | 1          |
| 8        | STEM PACKING   | PTFE     | *          |
| 9        | GLAND NUT      | AISI 304 | 1          |
| 10       | STEM WASHER    | AISI 304 | 1          |
| 11       | STEM NUT       | AISI 304 | 1          |
| 12       | HANDLE         | AISI 304 | 1          |
| 13       | HANDLE SLEEVE  | VINYL    | 1          |
| 14       | LOCKING DEVICE | AISI 304 | 1          |
| 15       | BOLT           | AISI 304 | *          |
| 16       | BOLT NUT       | AISI 304 | *          |
| 17       | BOLT WASHER    | AISI 304 | *          |
| 18       | HANDLE WASHER  | AISI 304 | 1          |

\* Depending on size.

| SIZE   | A    | B    | C    | D    | E    | F    | CV   | WEIGHT LBS |
|--------|------|------|------|------|------|------|------|------------|
| 1/4"   | 0.46 | 2.23 | 0.73 | 2.13 | 4.02 | 0.2  | 8    | 0.77       |
| 3/8"   | 0.5  | 2.23 | 0.73 | 2.13 | 4.02 | 0.2  | 10   | 0.77       |
| 1/2"   | 0.59 | 2.59 | 0.93 | 2.52 | 5.2  | 0.26 | 15   | 1.23       |
| 3/4"   | 0.79 | 3    | 1.1  | 2.64 | 5.2  | 0.26 | 34   | 1.65       |
| 1"     | 0.98 | 3.39 | 1.34 | 2.95 | 6.58 | 0.32 | 56   | 2.29       |
| 1 1/4" | 1.26 | 4.05 | 1.67 | 3.15 | 6.58 | 0.32 | 85   | 3.84       |
| 1 1/2" | 1.5  | 4.7  | 2.09 | 3.54 | 7.56 | 0.38 | 125  | 5.31       |
| 2"     | 1.97 | 5.17 | 2.54 | 3.86 | 7.56 | 0.38 | 250  | 8.07       |
| 2 1/2" | 2.56 | 6.46 | 3.43 | 5.39 | 9.92 | 0.47 | 320  | 15.65      |
| 3"     | 3.15 | 7.19 | 3.9  | 5.79 | 9.92 | 0.47 | 580  | 23.15      |
| 4"     | 3.94 | 9.28 | 5    | 6.89 | 11.1 | 0.59 | 1020 | 45.78      |