

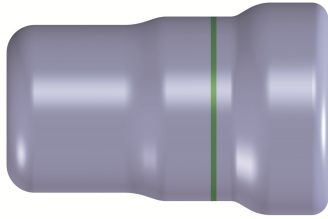

BONOMI
NORTH AMERICA

BONOMI
press
max

5M53



Carbon steel P plug from 1/2" to 4".

NEW

Technical specifications

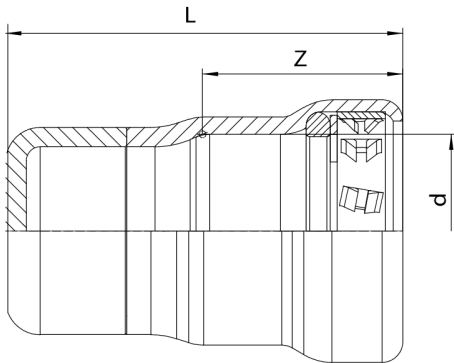

SIZE	L	Z
1/2"	2.15	1.06
3/4"	2.26	1.14
1"	2.42	1.34
1 1/4"	2.93	1.81
1 1/2"	3.01	1.89
2"	3.11	1.97

