

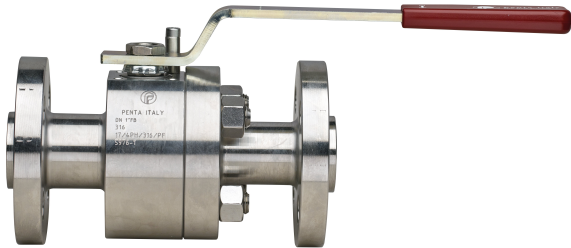

BONOMI
NORTH AMERICA



AP606CS - AP606SS FLANGED BALL VALVES ANSI 600

Metal seated floating ball valves, **bi-directional**.

- 2-piece bolted body from barstock.
- Temperature range carbon steel valve: $-20^{\circ}\text{F} \div +662^{\circ}\text{F}$.
- Temperature range stainless steel valve: $-40^{\circ}\text{F} \div +662^{\circ}\text{F}$.
- Blow-out proof stem.
- PENTAFITE standard ball seats, other metal seats on request.
- For high temperature clean services.
- API 598 Bubble Tight (Exceed ANSI B16.104/ FCI 70-2 CL.VI).
- Adjustable, live-loaded graphite packing.
- 100 mm stem elongation STD.
- API 607 fire tested.
- Locking lever operator available on request.
- NACE MR01-75 compliant materials.

NEW

Technical specifications

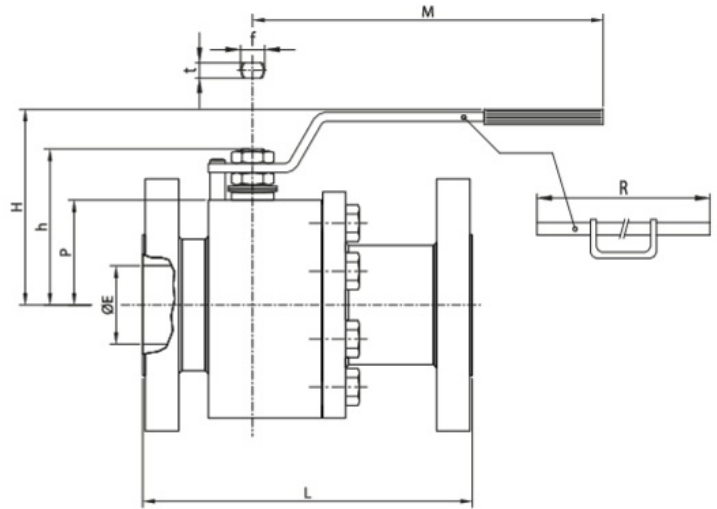
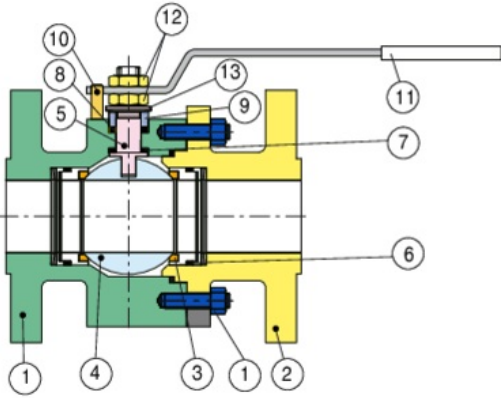

Ratings

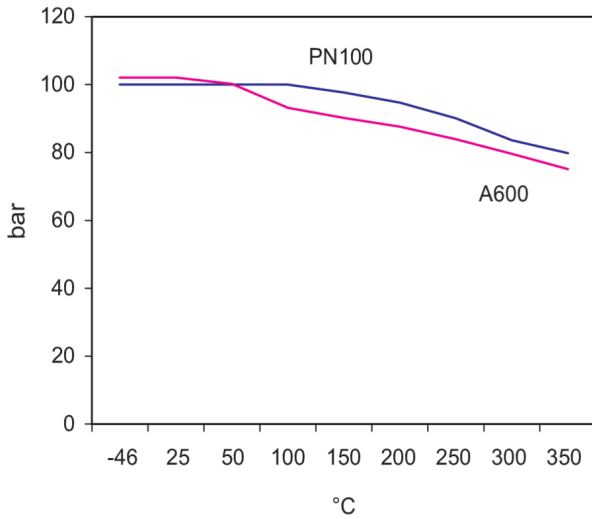

POSITION	PART NAME	MATERIAL	N.° PIECES
1	BODY/CONNECTOR BOLTS	F316 - A105	1
2	END CAP	F316 - A105	1
3	SEAT	PENTAFITE-WC-ST6-CRC-LIVE LOADED PEEK	2
4	BALL	F316 - A105	1
4	BALL COATING	HARD CHROMIUM NITRIDES (HCR) HVOF TUNGSTEN CARBIDES (WC) HVOF STELLITE GR.6 (ST6) HVOF CHROME CARBIDES (CRC)	1
5	STEM	17-4 PH	1
6	SEAL BODY	GRAPHITE	1
7	PRIMARY STEM SEAL	GRAPHITE	1
8	SECONDARY STEM SEAL	GRAPHITE	1
9	GLAND BOLT	304 SST	1
10	STOP PLATE	304 SST	1
11	HANDLE	CARBON ST. - S.S.	1
12	STEM NUTS	A193-B8 - A193-B7	2
13	STEM SPRING	304SS	1

SIZE	E	L	H	H	P	M	R	F/T	S	ISO 5211	BREAK TORQUE IN-LBS PENTAFITE SEATS	CV	WEIGHT LBS
1/2"	0.55	6.5	3.35	2.05	1.3	5.15	-	0.39/0.24	0.21	F03	283	27	15.43
3/4"	0.75	7.5	3.42	2.17	1.42	5.15	-	0.39/0.24	0.21	F03	487	59	18.74
1"	0.94	8.5	3.98	2.99	2.01	10.83	-	0.63/0.39	0.32	F05	610	113	22.05
1 1/2"	1.49	9.5	4.96	4.13	2.56	14.96	-	0.86/0.55	0.47	F07	1133	247	40.79
2"	2.00	11.5	5.31	4.45	2.95	14.96	-	0.86/0.55	0.45	F07	1930	488	55.12
2 1/2"	2.52	13	6.61	5.35	3.54	17.32	19.69	1.18/0.70	0.67	F10	3115	835	83.78
3"	2.99	14	6.77	5.55	3.74	17.32	19.69	1.18/0.70	0.67	F10	3292	1200	110.23